



MAITTM Industries

Monitoring and Control Solutions for Agriculture, Turf and the Environment

1300 739 920
www.mait.com.au

PLiFiX



www.mait.com.au

The smart indicator for lawn and garden.

PLiFiX is a new instantaneous ground marking system using synthetic grass tufts (Patent & registered trade mark).

The screw-in tufts are extremely tough and cannot be pulled out or damaged by trampling, mowing or any lawn care products currently used in the natural environment.

They can be used temporarily or permanently as a durable, aesthetic and discreet marker for buried objects or to set accurate and clear boundaries better than any plan. The colours correspond to international conventions for the marking of services.

Widely used by outdoor professionals (golf courses, landscape gardening), PLiFiX is easy to fit, completely safe to use, lasts for years and will not damage mowing or other equipment.



Fibres

U.V. resistant.

Sand

to fill the gap between the fibres and reinforce the grip.

Screw

Harpoon style screw made to resist against pulling out.

(NB: the PLiFiX is not screwed but driven into the ground using a mallet and the special driving-tool delivered with each set.)

1 Push

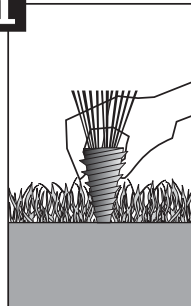

2 Driving-tool

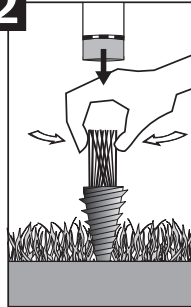

3 Mallet

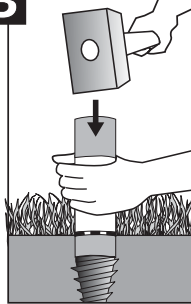

4 Sand

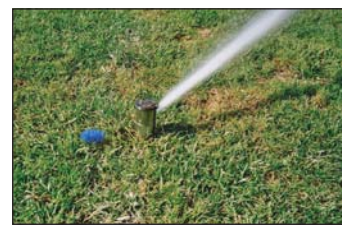
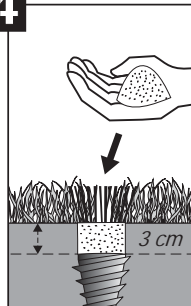

Blue PLiFiX mark the exact position of hidden sprinklers and buried ater pipes and indicate any change of direction, thus avoiding the risk of damage during maintenance works.



These red PLiFiX show the line of your electricity cables (telecom & CCTV, entry phone, pet restraint fences). You no longer need to go to great length to find them again.

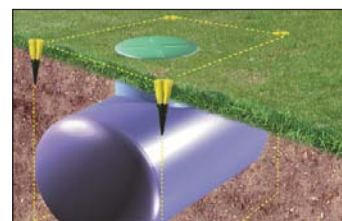

Gas tanks are buried for security and aesthetic reasons. Four yellow LiFiX (the conventional colour for gas) are used to mark out their exact location.



Sports pitches: season after season, the PLiFiX mark out the playing areas, ensure the precision of the measurements and facilitate the marking of the lines.



Arrange the PLiFiX in the shape of your choice, be it circle, square or star, so that they can easily be seen from a distance.